

Dear Families,

We have exciting news regarding signing in to the student tablets!

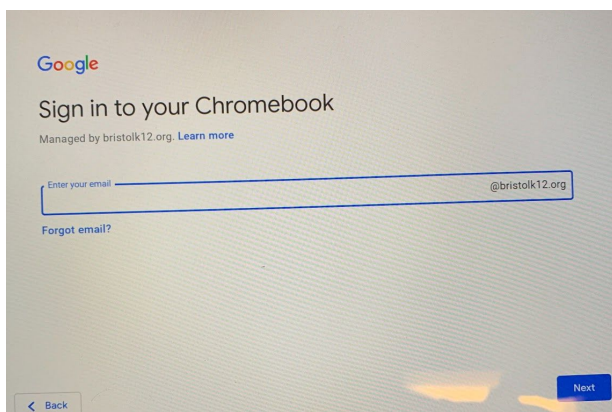

In the past, when students have powered on their tablets, this is the screen that they have seen.

They have had to sign in using their Google username and password, which has made it difficult for our younger learners to log in independently.

Students will now be able to sign into their tablets using a Clever QR Code Badge.

Students will still be able to choose to sign in using their Google username and password.

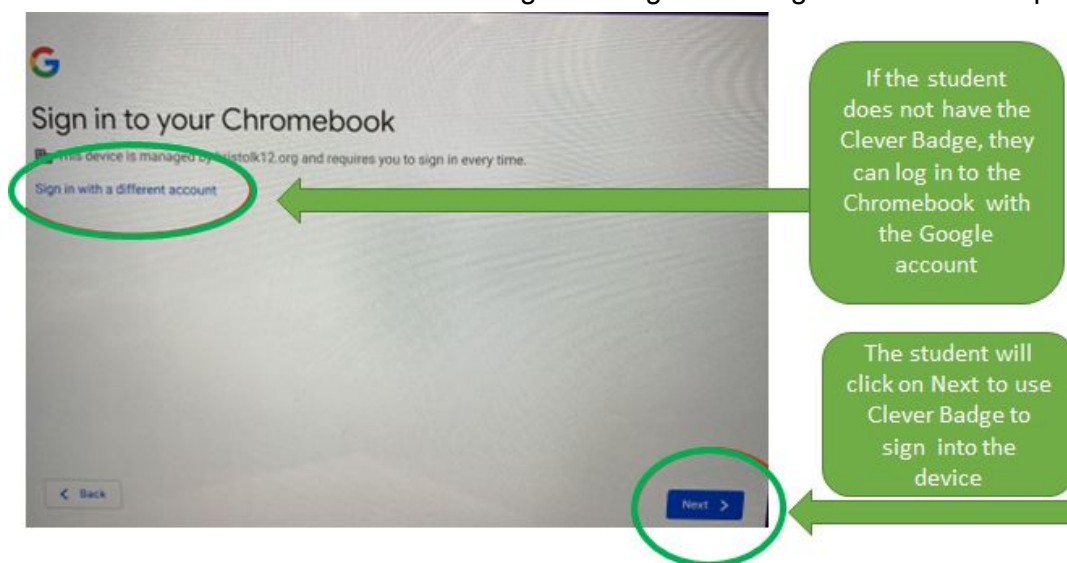

- Click NEXT to sign in using the Clever Badge
- The camera will activate, then hold the Clever Badge up to the camera (front screen of tablet)
- The student will then be logged into the tablet AND Clever
- Students can go to Clever, and will automatically be signed in to access Seesaw, ST Math, and Lexia
- Students can download their own badge. In Clever, click on Student Name then Click on Download Badge. Save and print the badge.

We are hopeful that this will make the process of signing in easier for our young students. Please note, it is important to power off and fully charge the tablet each night so that it will update. If you have any questions or concerns, please don't hesitate to reach out!